

NOTICE!!

These documents have been scanned!

Do not place un-scanned documents beneath this notice!

Do not remove this notice from this file!

GPO Jacket No. 560-102
Print Order 61540
Rise Business Services, LLC
Job=AZ15 5/13/2019



Box Number= AZ15045



Claim Begin-End: AMC417345-AMC417345

1 Initial Receipt



AZ15045-9

AMC416896-AMC417639

United States Department of the Interior
 Bureau of Land Management
 LANDS/RECREATION & PLANNING
 ONE N CENTRAL AVE
 PHOENIX, AZ 85004 -2203
 Phone: 602-417-9200

Receipt

No: 2647437

| | | | |
|---|--|------------------------------|--|
| Transaction #: 2728208 | | ENTERED INTO COMPUTER | |
| Date of Transaction: 08/31/2012 | | SEP 18 2012 <i>PS</i> | |
| CUSTOMER: | | | |
| DWIGHT WILLIAMS PO BOX 549 SALOME, AZ 85348-0549 US | | | |

| LINE # | QTY | DESCRIPTION | REMARKS | UNIT PRICE | TOTAL |
|---------------|------|---|-----------------------------|------------|-----------------|
| 1 | 1.00 | LOCATABLE MINERALS / MINING CLAIMS-NEW, UNADJUD, ONE OR MORE AUTH NOS / NEW MINING CLAIM PROCESSING FEE \$15 CASES: AMC417345/\$15.00 | | - n/a - | 15.00 |
| 2 | 1.00 | LOCATABLE MINERALS / MINING CLAIMS-NEW, UNADJUD, ONE OR MORE AUTH NOS / NEW MINING CLAIM LOCATION FEE \$34 CASES: AMC417345/\$34.00 | | - n/a - | 34.00 |
| 3 | 1.00 | LOCATABLE MINERALS / MINING CLAIMS-NEW, UNADJUD, ONE OR MORE AUTH NOS / NEW MINING CLAIM MAINT FEE \$140 CASES: AMC417345/\$140.00 | | - n/a - | 140.00 |
| 4 | 1.00 | LOCATABLE MINERALS / MINING CLAIMS-NOT NEW-UNADJUD, ONE AUTH NO. ONLY / MINING CLAIM MONEY RECEIVED CASES: AMC417346/\$280.00 | MAINT (1) 2012, 2013 (1) | - n/a - | 280.00 |
| TOTAL: | | | | | \$469.00 |

over paid

| PAYMENT INFORMATION | | | |
|---------------------|-----------|---|----------------------|
| 1 | AMOUNT: | 469.00 | POSTMARKED: N/A |
| | TYPE: | CHECK | RECEIVED: 08/31/2012 |
| | CHECK NO: | 25327 | |
| | NAME: | WILLIAMS, DWIGHT PO BOX 549 SALOME AZ 85348-0549 US | |

NOTICE!!

These documents have been scanned!

Do not place un-scanned documents beneath this notice!

Do not remove this notice from this file!

GPO Jacket No. 560-102
Print Order 61540
Rise Business Services, LLC
Job=AZ15 5/13/2019



Box Number= AZ15045



Claim Begin-End: AMC417345-AMC417345

2 Correspondence



AZ15045-9

AMC416896-AMC417639

AMC 417345

Authorized Date 10/16/2012

Instructions to Accounts AZ BLM REFUND \$10 TO DWIGHT WILLIAMS FOR
OVERPAYMENT OF MAINTENANCE FEES FOR AMC417345.
RECEIPT# 2647440. RE.

Login ID 4105

Entry Date 10/16/2012

Total Amount \$140.00

NOTICE!!

These documents have been scanned!

Do not place un-scanned documents beneath this notice!

Do not remove this notice from this file!

GPO Jacket No. 560-102
Print Order 61540
Rise Business Services, LLC
Job=AZ15 5/13/2019



Box Number= AZ15045



Claim Begin-End: AMC417345-AMC417345

3 Transfers



AZ15045-9

AMC416896-AMC417639

**NO
DOCUMENTS
FOUND**

NO DOCUMENTS FOUND
NO DOCUMENTS FOUND

NOTICE!!

These documents have been scanned!

Do not place un-scanned documents beneath this notice!

Do not remove this notice from this file!

GPO Jacket No. 560-102
Print Order 61540
Rise Business Services, LLC
Job=AZ15 5/13/2019



Box Number= AZ15045



Claim Begin-End: AMC417345-AMC417345

4 Miscellaneous



AZ15045-9

AMC416896-AMC417639

**NO
DOCUMENTS
FOUND**

NO DOCUMENTS FOUND
NO DOCUMENTS FOUND

NOTICE!!

These documents have been scanned!

Do not place un-scanned documents beneath this notice!

Do not remove this notice from this file!

GPO Jacket No. 560-102
Print Order 61540
Rise Business Services, LLC
Job=AZ15 5/13/2019



Box Number= AZ15045



Claim Begin-End: AMC417345-AMC417345

5 Annual Filings



AZ15045-9

AMC416896-AMC417639

DEPARTMENT OF THE INTERIOR
BUREAU OF LAND MANAGEMENT
MINING CLAIMS

Run Date/Time: 9/5/2019

MC Maintenance Fees Paid Through the BLM Pay Portal
(by Date Paid)

Page 474 Of 521

CBS Receipt: 4553264

Printed For Lead File # AMC417345

Agency Tracking ID: 1567389762

Assessment Year: 2020

Number of BLM Serial Nr: 13

Paid On: 9/2/2019

Total Amount Paid: \$2,310.00

| Claim Name | BLM Serial No | Lead File No | Amount Paid |
|------------------|---------------|--------------|-------------|
| LUCKY LODGE GOLD | AMC390543 | AMC390539 | \$330.00 |
| SOCCORO GOLD #2 | AMC410336 | AMC410336 | \$165.00 |
| SOCCORO GOLD #3 | AMC410337 | AMC410336 | \$165.00 |
| SOCCORO GOLD #4 | AMC410338 | AMC410336 | \$165.00 |
| SOCCORO GOLD #5 | AMC410339 | AMC410336 | \$165.00 |
| SOCCORO GOLD #6 | AMC410340 | AMC410336 | \$165.00 |
| SOCCORO GOLD #7 | AMC410341 | AMC410336 | \$165.00 |
| SOCCORO GOLD #8 | AMC410342 | AMC410336 | \$165.00 |
| SOCCORO GOLD #9 | AMC410343 | AMC410336 | \$165.00 |
| BONNY GOLD | AMC417345 | AMC417345 | \$165.00 |
| SLIPPER | AMC417346 | AMC417346 | \$165.00 |
| TREASURE | AMC417506 | AMC417506 | \$165.00 |
| WILLIAMS | AMC418338 | AMC418338 | \$165.00 |

United States Department of the Interior
Bureau of Land Management
 BUSINESS & SUPPORT SVCS DIV
 ONE N CENTRAL AVE SUITE 800
 PHOENIX, AZ 85004 -4427
 Phone: 602-417-9200

Receipt

No: 4553264

| | |
|--|--|
| Transaction #: 4674343 | |
| Date of Transaction: 09/01/2019 | |
| CUSTOMER: | |
| TPS PRODUCTS LLC NOT APPLICABLE DENVER,CO 80225 US | |

| LINE # | QTY | DESCRIPTION | REMARKS | UNIT PRICE | TOTAL |
|---------------|------|--|---------|------------|-------------------|
| 1 | 1.00 | LOCATABLE MINERALS / MINING CLAIMS- NOT NEW-UNADJUD,ONE AUTH NO. ONLY / MINING CLAIM MONEY RECEIVED CASES: AMC390543/\$2310.00 | | - n/a - | 2310.00 |
| TOTAL: | | | | | \$2,310.00 |

| PAYMENT INFORMATION | | | | | |
|---------------------|---------|--|-------------|------------|--|
| 1 | AMOUNT: | 2310.00 | POSTMARKED: | N/A | |
| | TYPE: | EFT | RECEIVED: | 09/01/2019 | |
| | NAME: | TPS PRODUCTS LLC NOT APPLICABLE DENVER CO 80225 US | | | |

| |
|---------|
| REMARKS |
| |

This receipt was generated by the automated BLM Collections and Billing System and is a paper representation of a portion of the official electronic record contained therein.

DEPARTMENT OF THE INTERIOR
BUREAU OF LAND MANAGEMENT
MINING CLAIMS

Run Date/Time: 9/11/2018

MC Maintenance Fees Paid Through the BLM Pay Portal
(by Date Paid)

Page 629 Of 723

CBS Receipt: 4252498

Printed For Lead File # AMC417345

Agency Tracking ID: 1535734455

Assessment Year: 2019

Number of BLM Serial Nr: 7

Paid On: 8/31/2018

Total Amount Paid: \$1,085.00

| Claim Name | BLM Serial No | Lead File No | Amount Paid |
|-----------------|---------------|--------------|-------------|
| SOCCORO GOLD #7 | AMC410341 | AMC410336 | \$155.00 |
| SOCCORO GOLD #8 | AMC410342 | AMC410336 | \$155.00 |
| SOCCORO GOLD #9 | AMC410343 | AMC410336 | \$155.00 |
| BONNY GOLD | AMC417345 | AMC417345 | \$155.00 |
| SLIPPER | AMC417346 | AMC417346 | \$155.00 |
| TREASURE | AMC417506 | AMC417506 | \$155.00 |
| WILLIAMS | AMC418338 | AMC418338 | \$155.00 |

United States Department of the Interior

Bureau of Land Management
 BUSINESS & SUPPORT SVCS DIV
 ONE N CENTRAL AVE SUITE 800
 PHOENIX, AZ 85004 -4427
 Phone: 602-417-9200

Receipt

No: 4252498

| | |
|--|--|
| Transaction #: 4368016 | |
| Date of Transaction: 08/31/2018 | |
| CUSTOMER: | |
| DWIGHT WILLIAMS P.O. BOX 549 SALOME, AZ 85348 US | |

| LINE # | QTY | DESCRIPTION | REMARKS | UNIT PRICE | TOTAL |
|---------------|------|---|---------|------------|-------------------|
| 1 | 1.00 | LOCATABLE MINERALS / MINING CLAIMS-NOT NEW-UNADJUD, ONE AUTH NO. ONLY / MINING CLAIM MONEY RECEIVED CASES: AMC410341/\$1085.00 | | - n/a - | 1085.00 |
| TOTAL: | | | | | \$1,085.00 |

| PAYMENT INFORMATION | | | |
|---|---------------|---|----------------------|
| NOTE: Items will appear on credit card statement as "BLM O Mining Claim". | | | |
| 1 | AMOUNT: | 1085.00 | POSTMARKED: N/A |
| | TYPE: | CREDIT CARD | RECEIVED: 08/31/2018 |
| | NAME: | DWIGHT WILLIAMS P.O. BOX 549 SALOME AZ 85348 US | |
| | CARD NO: | XXXXXXXXXXXX2817 | AUTH CODE: 111365 |
| | NAME ON CARD: | DWIGHT WILLIAMS | |
| | SIGNATURE: | | |

| REMARKS |
|---------|
| |

This receipt was generated by the automated BLM Collections and Billing System and is a paper representation of a portion of the official electronic record contained therein.

Run Date: 09/05/17

Run Time: 02:33 PM

**DEPARTMENT OF THE INTERIOR
BUREAU OF LAND MANAGEMENT
MINING CLAIMS**

MC Maintenance Fees Paid Through the BLM Pay Portal

CBS Receipt: 3968437

Printed For Lead File # AMC417345

Agency Tracking ID: 1504215924

Number of BLM Serial Nr: 12

Assessment Year: 2018

Total Amount Paid: \$1,860.00

Paid On: 08/31/2017

| Claim Name | BLM Serial No | Lead File No | Amount Paid |
|-----------------|---------------|--------------|-------------|
| SOCCORO GOLD #2 | AMC410336 | AMC410336 | \$155.00 |
| SOCCORO GOLD #3 | AMC410337 | AMC410336 | \$155.00 |
| SOCCORO GOLD #4 | AMC410338 | AMC410336 | \$155.00 |
| SOCCORO GOLD #5 | AMC410339 | AMC410336 | \$155.00 |
| SOCCORO GOLD #6 | AMC410340 | AMC410336 | \$155.00 |
| SOCCORO GOLD #7 | AMC410341 | AMC410336 | \$155.00 |
| SOCCORO GOLD #8 | AMC410342 | AMC410336 | \$155.00 |
| SOCCORO GOLD #9 | AMC410343 | AMC410336 | \$155.00 |
| BONNY GOLD | AMC417345 | AMC417345 | \$155.00 |
| SLIPPER | AMC417346 | AMC417346 | \$155.00 |
| TREASURE | AMC417506 | AMC417506 | \$155.00 |
| WILLIAMS | AMC418338 | AMC418338 | \$155.00 |

United States Department of the Interior
Bureau of Land Management
 BUSINESS & SUPPORT SVCS DIV
 ONE N CENTRAL AVE SUITE 800
 PHOENIX, AZ 85004 -4427
 Phone: 602-417-9200

Receipt

No: 3968437

| | |
|--|--|
| Transaction #: 4078334 | |
| Date of Transaction: 08/31/2017 | |
| CUSTOMER: | |
| DWIGHT WILLIAMS P.O. BOX 549 SALOME, AZ 85348 US | |

| LINE # | QTY | DESCRIPTION | REMARKS | UNIT PRICE | TOTAL |
|---------------|------|--|---------|------------|-------------------|
| 1 | 1.00 | LOCATABLE MINERALS / MINING CLAIMS- NOT NEW-UNADJUD, ONE AUTH NO. ONLY / MINING CLAIM MONEY RECEIVED CASES: AMC410341/\$1860.00 | | - n/a - | 1860.00 |
| TOTAL: | | | | | \$1,860.00 |

| PAYMENT INFORMATION | | | | | |
|---|---------------|---|-------------|------------|--|
| NOTE: Items will appear on credit card statement as "BLM O Mining Claim". | | | | | |
| 1 | AMOUNT: | 1860.00 | POSTMARKED: | N/A | |
| | TYPE: | CREDIT CARD | RECEIVED: | 08/31/2017 | |
| | NAME: | DWIGHT WILLIAMS P.O. BOX 549 SALOME AZ 85348 US | | | |
| | CARD NO: | XXXXXXXXXXXX6454 | AUTH CODE: | 068252 | |
| | NAME ON CARD: | DWIGHT WILLIAMS | | | |
| | EXPIRES: | 06/2020 | | | |
| | SIGNATURE: | | | | |

| |
|---------|
| REMARKS |
| |

This receipt was generated by the automated BLM Collections and Billing System and is a paper representation of a portion of the official electronic record contained therein.

Run Date: 09/09/16

Run Time: 05:54 AM

**DEPARTMENT OF THE INTERIOR
BUREAU OF LAND MANAGEMENT
MINING CLAIMS**

MC Maintenance Fees Paid Through the BLM Pay Portal

CBS Receipt: 3641848

Printed For Lead File # **AMC417345**

Agency Tracking ID: 1472165650

Assessment Year: 2017

Number of BLM Serial Nr: 13

Paid On: 08/25/2016

Total Amount Paid: \$2,170.00

| Claim Name | BLM Serial No | Lead File No | Amount Paid |
|-----------------|---------------|--------------|-------------|
| LUCKY LODE GOLD | AMC390543 | AMC390539 | \$310.00 |
| SOCCORO GOLD #2 | AMC410336 | AMC410336 | \$155.00 |
| SOCCORO GOLD #3 | AMC410337 | AMC410336 | \$155.00 |
| SOCCORO GOLD #4 | AMC410338 | AMC410336 | \$155.00 |
| SOCCORO GOLD #5 | AMC410339 | AMC410336 | \$155.00 |
| SOCCORO GOLD #6 | AMC410340 | AMC410336 | \$155.00 |
| SOCCORO GOLD #7 | AMC410341 | AMC410336 | \$155.00 |
| SOCCORO GOLD #8 | AMC410342 | AMC410336 | \$155.00 |
| SOCCORO GOLD #9 | AMC410343 | AMC410336 | \$155.00 |
| BONNY GOLD | AMC417345 | AMC417345 | \$155.00 |
| SLIPPER | AMC417346 | AMC417346 | \$155.00 |
| TREASURE | AMC417506 | AMC417506 | \$155.00 |
| WILLIAMS | AMC418338 | AMC418338 | \$155.00 |

United States Department of the Interior
Bureau of Land Management
 BUSINESS & SUPPORT SVCS DIV
 ONE N CENTRAL AVE SUITE 800
 PHOENIX, AZ 85004 -4427
 Phone: (602) 417-9200

Receipt

No: 3641848

| | |
|--|--|
| Transaction #: 3745796 | |
| Date of Transaction: 08/25/2016 | |
| CUSTOMER: | |
| DWIGHT WILLIAMS P.O. BOX 549 SALOME, AZ 85348 US | |

| LINE # | QTY | DESCRIPTION | REMARKS | UNIT PRICE | TOTAL |
|---------------|------|---|---------|------------|-------------------|
| 1 | 1.00 | LOCATABLE MINERALS / MINING CLAIMS- NOT NEW-UNADJUD, ONE AUTH NO. ONLY / MINING CLAIM MONEY RECEIVED CASES: AMC410341/\$2170.00 | | - n/a - | 2170.00 |
| TOTAL: | | | | | \$2,170.00 |

| PAYMENT INFORMATION | | | |
|---|---------------|---|----------------------|
| NOTE: Items will appear on credit card statement as "BLM O Mining Claim". | | | |
| 1 | AMOUNT: | 2170.00 | POSTMARKED: N/A |
| | TYPE: | CREDIT CARD | RECEIVED: 08/25/2016 |
| | NAME: | DWIGHT WILLIAMS P.O. BOX 549 SALOME AZ 85348 US | |
| | CARD NO: | XXXXXXXXXXXX6454 | AUTH CODE: 076582 |
| | NAME ON CARD: | DWIGHT WILLIAMS | |
| | EXPIRES: | 06/2020 | |
| | SIGNATURE: | | |

| |
|----------------|
| REMARKS |
| |

This receipt was generated by the automated BLM Collections and Billing System and is a paper representation of a portion of the official electronic record contained therein.

Run Date: 09/08/15

Run Time: 09:20 AM

**DEPARTMENT OF THE INTERIOR
BUREAU OF LAND MANAGEMENT
MINING CLAIMS**

MC Maintenance Fees Paid Through the BLM Pay Portal

CBS Receipt: 3382751

Printed For Lead File # AMC417345

Agency Tracking ID: 1441053829

Number of BLM Serial Nr: 13

Assessment Year: 2016

Paid On: 08/31/2015

Total Amount Paid: \$2,170.00

| Claim Name | BLM Serial No | Lead File No | Amount Paid |
|-----------------|---------------|--------------|-------------|
| LUCKY LODE GOLD | AMC390543 | AMC390539 | \$310.00 |
| SOCCORO GOLD #2 | AMC410336 | AMC410336 | \$155.00 |
| SOCCORO GOLD #3 | AMC410337 | AMC410336 | \$155.00 |
| SOCCORO GOLD #4 | AMC410338 | AMC410336 | \$155.00 |
| SOCCORO GOLD #5 | AMC410339 | AMC410336 | \$155.00 |
| SOCCORO GOLD #6 | AMC410340 | AMC410336 | \$155.00 |
| SOCCORO GOLD #7 | AMC410341 | AMC410336 | \$155.00 |
| SOCCORO GOLD #8 | AMC410342 | AMC410336 | \$155.00 |
| SOCCORO GOLD #9 | AMC410343 | AMC410336 | \$155.00 |
| BONNY GOLD | AMC417345 | AMC417345 | \$155.00 |
| SLIPPER | AMC417346 | AMC417346 | \$155.00 |
| TREASURE | AMC417506 | AMC417506 | \$155.00 |
| WILLIAMS | AMC418338 | AMC418338 | \$155.00 |

**United States Department of the Interior
Bureau of Land Management
BUSINESS & SUPPORT SVCS DIV
ONE N CENTRAL AVE SUITE 800
PHOENIX, AZ 85004 -4427
Phone: (602) 417-9200**

Receipt

No: 3382751

| | |
|---|--|
| Transaction #: 3481065 | |
| Date of Transaction: 08/31/2015 | |
| CUSTOMER: | |
| DWIGHT WILLIAMS PO BOX 129 TOMBSTONE, AZ 85638 US | |

| LINE # | QTY | DESCRIPTION | REMARKS | UNIT PRICE | TOTAL |
|---------------|------|---|---------|------------|-------------------|
| 1 | 1.00 | LOCATABLE MINERALS / MINING CLAIMS- NOT NEW-UNADJUD, ONE AUTH NO. ONLY / MINING CLAIM MONEY RECEIVED CASES: AMC410341/\$2170.00 | | - n/a - | 2170.00 |
| TOTAL: | | | | | \$2,170.00 |

| PAYMENT INFORMATION | | | | | |
|---|---------------|--|-------------|------------|--|
| NOTE: Items will appear on credit card statement as "BLM O Mining Claim". | | | | | |
| 1 | AMOUNT: | 2170.00 | POSTMARKED: | N/A | |
| | TYPE: | CREDIT CARD | RECEIVED: | 08/31/2015 | |
| | NAME: | DWIGHT WILLIAMS PO BOX 129 TOMBSTONE AZ 85638 US | | | |
| | CARD NO: | XXXXXXXXXXXX4130 | AUTH CODE: | 321904 | |
| | NAME ON CARD: | DWIGHT WILLIAMS | | | |
| | EXPIRES: | 08/2016 | | | |
| | SIGNATURE: | | | | |

| |
|---------|
| REMARKS |
| |

This receipt was generated by the automated BLM Collections and Billing System and is a paper representation of a portion of the official electronic record contained therein.

417345
 417346
 417506
 418338
 390539
 410336

MAINTENANCE FEE PAYMENT

Claimant Name: Dwight Williams
 Address: P.O. Box 549
 City: Salome State: AZ Zip: 85348
 Telephone: 541-306-1704
 E-mail address: dwilliams@epsproducts.com
 Signature: [Signature]

Check here if this is a change of address.

RECEIVED
 BLM AZ STATE OFFICE
 2013 AUG 28 P 1:44
 PHOENIX, ARIZONA
 BLM
 Date
 Stamp

| LINE NO. | AMC NUMBER | CLAIM/SITE NAME | COUNTY RECORDER DATA (If available) | TWP | RNG | SEC |
|----------|------------|-----------------|-------------------------------------|-----|-----|-----|
| 1 | 417346 | Slipper | | 04N | 13W | 014 |
| 2 | 417506 | Treasure | | 05N | 11W | 029 |
| 3 | 417345 | Bonny Gold | | 04N | 13W | 001 |
| 4 | 418338 | Williams | | 05N | 11W | 019 |
| 5 | 390543 | Lucky Lode Gold | | 04N | 13W | 001 |
| 6 | 410336 | Socorro Gold #2 | | 05N | 12W | 025 |
| 7 | 410337 | Socorro Gold #3 | | 05N | 12W | 025 |
| 8 | 410338 | Socorro Gold #4 | | 05N | 12W | 025 |
| 9 | 410339 | Socorro Gold #5 | | 05N | 12W | 026 |
| 10 | 410340 | Socorro Gold #6 | | 05N | 12W | 026 |

List additional claims on Form MCF114.

page 1 of 2

Bureau of Land Management
 Arizona State Office
 www.blm.gov/az/

No. of Claims: 14 x \$140 = 1,960.00
 Check No: 2621 Init. [Signature]
 Receipt No.: 2868296
 For BLM Use Only

Form: MCF112
 Revised July 2009

This form is available from the Arizona Department of Mines and Mineral Resources and may be reproduced.

ENTERED
 SEP - 6 2013
 BY: RE

SUPPLEMENTAL ATTACHMENT

page 2 of 2

RECEIVED
BLM AZ STATE OFFICE
2013 AUG 28 P 1:44
PHOENIX, ARIZONA

BLM
Date
Stamp

May be used with the following forms for listing additional mining claims:

Check One.

- Affidavit of Performance of Annual Work
- Maintenance Fee Payment
- Notice of Intent to Hold Mining Claims
- Notice of Non-Liability for Labor and Materials Furnished

| LINE NO. | AMC NUMBER | CLAIM/SITE NAME | COUNTY RECORDER DATA (If available) | TWP | RNG | SEC |
|----------|------------|------------------|-------------------------------------|-----|-----|-----|
| 11 | 410341 | Socorro Gold #7 | | 05N | 12W | 026 |
| 12 | 410342 | Socorro Gold #8 | | 05N | 12W | 026 |
| 13 | 410343 | Socorro Gold #9 | | 05N | 12W | 035 |
| 14 | 410344 | Socorro Gold #10 | | 05N | 12W | 035 |
| | | | | | | |
| | | | | | | |
| | | | | | | |
| | | | | | | |
| | | | | | | |
| | | | | | | |
| | | | | | | |
| | | | | | | |
| | | | | | | |
| | | | | | | |
| | | | | | | |
| | | | | | | |
| | | | | | | |
| | | | | | | |
| | | | | | | |
| | | | | | | |
| | | | | | | |
| | | | | | | |

Form MCF114
Revised June 2005

United States Department of the Interior
Bureau of Land Management
 LANDS/RECREATION & PLANNING
 ONE N CENTRAL AVE
 PHOENIX, AZ 85004 -2203
 Phone: 602-417-9200

Receipt

No: 2868296

| | |
|---|--|
| Transaction #: 2954254 | |
| Date of Transaction: 08/29/2013 | |
| CUSTOMER: | |
| DWIGHT WILLIAMS PO BOX 549 SALOME, AZ 85348-0549 US | |

| LINE # | QTY | DESCRIPTION | REMARKS | UNIT PRICE | TOTAL |
|---------------|------|---|---------------------------|------------|-------------------|
| 1 | 1.00 | LOCATABLE MINERALS / MINING CLAIMS-NOT NEW-UNADJUD, ONE AUTH NO. ONLY / MINING CLAIM MONEY RECEIVED CASES: AMC417346/\$1960.00 | MAINT FEE PYMNT (14) 2014 | - n/a - | 1960.00 |
| TOTAL: | | | | | \$1,960.00 |

| PAYMENT INFORMATION | | | | | |
|---------------------|-----------|---|-------------|------------|--|
| 1 | AMOUNT: | 1960.00 | POSTMARKED: | 08/27/2013 | |
| | TYPE: | CHECK | RECEIVED: | 08/28/2013 | |
| | CHECK NO: | 2621 | | | |
| | NAME: | TPS PRODUCTS LLC PO BOX 129 TOMBSTONE AZ 85638 US | | | |

| |
|---------|
| REMARKS |
| |

This receipt was generated by the automated BLM Collections and Billing System and is a paper representation of a portion of the official electronic record contained therein.

CBS Export Results Report

Include Resolved Records

Record Status

- Error Records (E/M/I)
- Accepted Records (A/W)
- "On Hold" Records (H)
- All Records (for s/n or receipt nr)
- Exported, No Results From CBS
- New (not yet exported)

Printable Format (legal/landscape)

Search Criteria

Enter export Date (mm/dd/yyyy)
 Serial Number match (optional)
 Receipt Nr (optional)
 Export Nr (exclusive)
 LR2000 User (defaults to login)

Responsible Area (Errors Only)

- User (U,X)
- Programmer (P,X)
- All (U,P,X)

[User Guide](#)

| Resend? | Export Nr | A/D | Serial Nr | Multi | Code | \$ Amount | Remarks | Receipt Nr | LR2000 User | #Msg | Resolved? | OK | Stat1 | Area | CBS Msg 1 | Stat2 | Area | Msg 2 | CBS 392 ID | 392 \$ Amt | Action Update Date | Resend | Resend Orig | Export Date |
|--------------------------|-----------|-----|-----------|-------|------|-----------|------------|------------|-------------|------|--------------------------|----|-------|------|-----------|-------|------|-------|------------|------------|--------------------|--------|-------------|-------------|
| <input type="checkbox"/> | 4372396 | A | AMC417346 | 682 | | 140.00 | 2014;\$140 | 2868296 | REBERT | 1 | <input type="checkbox"/> | | A | | ACCPT | | | | 1971233 | 1960.00 | 9/6/2013 15:17 | | | 9/6/2013 |
| <input type="checkbox"/> | 4372403 | A | AMC417506 | 682 | | 140.00 | 2014;\$140 | 2868296 | REBERT | 1 | <input type="checkbox"/> | | A | | ACCPT | | | | 1971233 | 1960.00 | 9/6/2013 15:18 | | | 9/6/2013 |
| <input type="checkbox"/> | 4372422 | A | AMC417345 | 682 | | 140.00 | 2014;\$140 | 2868296 | REBERT | 1 | <input type="checkbox"/> | | A | | ACCPT | | | | 1971233 | 1960.00 | 9/6/2013 15:18 | | | 9/6/2013 |
| <input type="checkbox"/> | 4372424 | A | AMC418338 | 682 | | 140.00 | 2014;\$140 | 2868296 | REBERT | 1 | <input type="checkbox"/> | | A | | ACCPT | | | | 1971233 | 1960.00 | 9/6/2013 15:18 | | | 9/6/2013 |
| <input type="checkbox"/> | 4372437 | A | AMC390543 | 682 | | 280.00 | 2014;\$280 | 2868296 | REBERT | 1 | <input type="checkbox"/> | | A | | ACCPT | | | | 1971233 | 1960.00 | 9/6/2013 15:19 | | | 9/6/2013 |
| <input type="checkbox"/> | 4372458 | A | AMC410336 | 682 | | 140.00 | 2014;\$140 | 2868296 | REBERT | 1 | <input type="checkbox"/> | | A | | ACCPT | | | | 1971233 | 1960.00 | 9/6/2013 15:19 | | | 9/6/2013 |
| <input type="checkbox"/> | 4372459 | A | AMC410337 | 682 | | 140.00 | 2014;\$140 | 2868296 | REBERT | 1 | <input type="checkbox"/> | | A | | ACCPT | | | | 1971233 | 1960.00 | 9/6/2013 15:19 | | | 9/6/2013 |
| <input type="checkbox"/> | 4372460 | A | AMC410338 | 682 | | 140.00 | 2014;\$140 | 2868296 | REBERT | 1 | <input type="checkbox"/> | | A | | ACCPT | | | | 1971233 | 1960.00 | 9/6/2013 15:19 | | | 9/6/2013 |
| <input type="checkbox"/> | 4372461 | A | AMC410339 | 682 | | 140.00 | 2014;\$140 | 2868296 | REBERT | 1 | <input type="checkbox"/> | | A | | ACCPT | | | | 1971233 | 1960.00 | 9/6/2013 15:19 | | | 9/6/2013 |
| <input type="checkbox"/> | 4372462 | A | AMC410340 | 682 | | 140.00 | 2014;\$140 | 2868296 | REBERT | 1 | <input type="checkbox"/> | | A | | ACCPT | | | | 1971233 | 1960.00 | 9/6/2013 15:19 | | | 9/6/2013 |
| <input type="checkbox"/> | 4372463 | A | AMC410341 | 682 | | 140.00 | 2014;\$140 | 2868296 | REBERT | 1 | <input type="checkbox"/> | | A | | ACCPT | | | | 1971233 | 1960.00 | 9/6/2013 15:19 | | | 9/6/2013 |
| <input type="checkbox"/> | 4372464 | A | AMC410342 | 682 | | 140.00 | 2014;\$140 | 2868296 | REBERT | 1 | <input type="checkbox"/> | | A | | ACCPT | | | | 1971233 | 1960.00 | 9/6/2013 15:19 | | | 9/6/2013 |
| <input type="checkbox"/> | 4372465 | A | AMC410343 | 682 | | 140.00 | 2014;\$140 | 2868296 | REBERT | 1 | <input type="checkbox"/> | | A | | ACCPT | | | | 1971233 | 1960.00 | 9/6/2013 15:19 | | | 9/6/2013 |

**DEPARTMENT OF THE INTERIOR
BUREAU OF LAND MANAGEMENT
MINING CLAIMS
(LIVE) Serial Register Page**

Run Date/Time: 12/04/2013 10:02 AM

Page 1 of 2

01 10-21-1976;090STAT0090;43USC1744

Case Type 384201: PLACER CLAIM

Claim Name: LUCKY LODE GOLD

Commodity :

Case Disposition: ACTIVE

Required Maintenance Fee: \$280.00

Total Acres

40.000

Serial Number

AMC390543

Lead File Number

AMC390539

| Name & Address | Int Rel |
|---|----------|
| WILLIAMS LORI PO BOX 549 SALOME, AZ 85348-0549 | CLAIMANT |
| WILLIAMS DWIGHT PO BOX 549 SALOME, AZ 85348-0549 | CLAIMANT |
| TPS PRODUCTS LLC 16840 FINLEY BUTTE RD LA PINE, OR 97739-9877 | CLAIMANT |
| AMOS RONNIE 16840 FINLEY BUTTE RD LA PINE, OR 97739-9877 | CLAIMANT |

| Mer Twp | Rng | Sec | Quadrant | District/Field Office | County |
|---------|-------|-------|----------|-----------------------|--------|
| 14 | 0040N | 0130W | 001 NW | LAKE HAVASU FO | LA PAZ |

| Act Date | Code | Action | Action Remarks | Receipt Number |
|------------|------|-----------------------------|----------------|----------------|
| 12/29/2007 | 403 | LOCATION DATE | | |
| 03/24/2008 | 395 | RECORDATION NOTICE RECD | 1 | 1677159 |
| 08/28/2013 | 682 | MAINTENANCE FEE/\$140 | 2014;\$280 | 2868296 |
| 08/31/2012 | 682 | MAINTENANCE FEE/\$140 | 2013;\$280 | 2647443 |
| 09/01/2011 | 682 | MAINTENANCE FEE/\$140 | 2012 | 2422848 |
| 08/10/2010 | 682 | MAINTENANCE FEE/\$140 | 2011 | 2187457 |
| 08/31/2009 | 682 | MAINTENANCE FEE/\$140 | 2010 | 1992791 |
| 12/03/2009 | 480 | EVID OF ASSMT FILED | 2009 | 2046366 |
| 08/25/2008 | 483 | SMALL MINER CERT FILED | 2009 | |
| 08/25/2008 | 480 | EVID OF ASSMT FILED | 2008 | 1770333 |
| 03/24/2008 | 484 | LOCATION YEAR / MAINTENANCE | 2008 | 1677159 |

NO WARRANTY IS MADE BY BLM
FOR USE OF THE DATA FOR
PURPOSES NOT INTENDED BY BLM

DEPARTMENT OF THE INTERIOR
BUREAU OF LAND MANAGEMENT
MINING CLAIMS

(LIVE) Serial Register Page

Run Date/Time: 12/04/2013 10:02 AM

Page 2 of 2

| | | | | |
|------------|-----|------------------------|-----------------------|---------|
| 02/03/2010 | 396 | TRF OF INTEREST FILED | MINEFINDER GOLD | 2077889 |
| 02/03/2010 | 396 | TRF OF INTEREST FILED | MINEFINDER GOLDC | 2077889 |
| 02/03/2010 | 396 | TRF OF INTEREST FILED | MINEFINDER GOLDB | 2077889 |
| 02/03/2010 | 396 | TRF OF INTEREST FILED | MINEFINDER GOLDA | 2077889 |
| 01/08/2010 | 396 | TRF OF INTEREST FILED | SEVERED TO AMC399060A | 2066098 |
| 01/08/2010 | 396 | TRF OF INTEREST FILED | SEVERED TO AMC399060 | 2066098 |
| 01/08/2010 | 396 | TRF OF INTEREST FILED | SEVERED TO AMC399060C | 2066098 |
| 01/08/2010 | 396 | TRF OF INTEREST FILED | SEVERED TO AMC399060B | 2066098 |
| 01/08/2010 | 410 | CASE SEGREGATED BY TRF | SEVERED TO AMC399060 | |
| 09/24/2008 | 396 | TRF OF INTEREST FILED | NOEL DAVE | 1792045 |
| 08/25/2008 | 396 | TRF OF INTEREST FILED | WALKER SOPHIE | 1770333 |
| 08/25/2008 | 396 | TRF OF INTEREST FILED | JUNGERS THERESA E | 1770333 |
| 08/25/2008 | 396 | TRF OF INTEREST FILED | KAROLYI STEVE | 1770333 |
| 08/25/2008 | 396 | TRF OF INTEREST FILED | GERSON STANLEY L | 1770333 |
| 08/25/2008 | 396 | TRF OF INTEREST FILED | MCNEILL H G | 1770333 |
| 08/25/2008 | 396 | TRF OF INTEREST FILED | MCNEILL ROY | 1770333 |
| 08/25/2008 | 396 | TRF OF INTEREST FILED | RAAB CAROLE B | 1770333 |
| 08/25/2008 | 396 | TRF OF INTEREST FILED | JUNGERS EDWARD F | 1770333 |
| 08/25/2008 | 396 | TRF OF INTEREST FILED | MCNEILL ELAINE | 1770333 |
| 07/29/2008 | 669 | LAND STATUS CHECKED | | |
| 03/24/2008 | 501 | ACCT ADV IN LEAD FILE | AMC390539; | |

Line Nr Remarks

0001 01/08/2010 - SEVERED TO AMC399060 - W2 NW4 SEC. 1

NO WARRANTY IS MADE BY BLM
FOR USE OF THE DATA FOR
PURPOSES NOT INTENDED BY BLM

DEPARTMENT OF THE INTERIOR
BUREAU OF LAND MANAGEMENT
MINING CLAIMS
(LIVE) Serial Register Page

Run Date/Time: 12/04/2013 09:59 AM

Page 1 of 1

01 05-10-1872;017STAT0091;30USC26,28,34

Total Acres
20.660

Serial Number
AMC410344

Case Type 384101: LODE CLAIM

Claim Name: SOCCORO GOLD #10

Lead File Number
AMC410336

Commodity :

Case Disposition: ACTIVE

Required Maintenance Fee: \$140.00

| Name & Address | | | | Int Rel |
|-----------------|------------|------------|------------|----------|
| WILLIAMS LORI | PO BOX 549 | SALOME, AZ | 85348-0549 | CLAIMANT |
| WILLIAMS DWIGHT | PO BOX 549 | SALOME, AZ | 85348-0549 | CLAIMANT |
| COX JIM | PO BOX 447 | SALOME, AZ | 85348-0447 | CLAIMANT |
| COX ALEXA | PO BOX 447 | SALOME, AZ | 85348-0447 | CLAIMANT |

| Mer Twp | Rng | Sec | Quadrant | District/Field Office | County |
|---------|-------|-------|----------|-----------------------|--------|
| 14 | 0050N | 0120W | 035 | NE LAKE HAVASU FO. | LA PAZ |

| Act Date | Code | Action | Action Remarks | Receipt Number |
|------------|------|-----------------------------|----------------------|----------------|
| 06/11/2011 | 403 | LOCATION DATE | | |
| 09/02/2011 | 395 | RECORDATION NOTICE RECD | 1 | 2424100 |
| 08/27/2012 | 682 | MAINTENANCE FEE/\$140 | 2013;\$140 | 2641497 |
| 09/02/2011 | 682 | MAINTENANCE FEE/\$140 | 2012 | 2424100 |
| 09/02/2011 | 484 | LOCATION YEAR / MAINTENANCE | 2011 | 2424100 |
| 03/28/2012 | 669 | LAND STATUS CHECKED | | |
| 09/02/2011 | 501 | ACCT ADV IN LEAD FILE | AMC410336-AMC401344; | |

Line Nr Remarks

NO WARRANTY IS MADE BY BLM
FOR USE OF THE DATA FOR
PURPOSES NOT INTENDED BY BLM

UNITED STATES
DEPARTMENT OF THE INTERIOR
BUREAU OF LAND MANAGEMENT
**MAINTENANCE FEE PAYMENT FORM FOR
LODE CLAIMS, MILL SITES, AND TUNNEL SITES**

AMC417345

Remitter Name: Dwight Williams
Mailing Address: P.O. Box 549
City, State, Zip: Salome, AZ 85348

Check here if this is a change of address.

RECEIVED
BLM AZ STATE OFFICE
2012 AUG 31 P 3:55
PHOENIX, ARIZONA
FOR COUNTY RECORDER'S USE

No. of claims/sites 1
x \$140 per claim/site
Total due BLM \$ 140.00

- The maintenance fee may be paid by cash, check, money order, Bureau of Land Management (BLM) Declining Deposit Account, or credit card (VISA, American Express, Discover, or MasterCard). Payments must be remitted to the BLM State Office where your claim or site is recorded and received on or before September 1. If the payment is mailed, the envelope must be postmarked by a bona fide delivery service on or before September 1 and received at the proper BLM State Office within 15 calendar days after the due date. Payments may also be made by telephone using a credit card. A complete listing of BLM State Offices with their addresses and phone numbers can be found at <http://www.blm.gov>.
- The maintenance fee for the following claim(s)/site(s) applies to the assessment year 2013.

| CLAIM/SITE NAME | BLM SERIAL NO. |
|--|----------------|
| <u>Bonny Gold</u> | <u>417345</u> |
| ENTERED INTO COMPUTER | |
| SEP 13 2012 PS | |
| | |
| | |
| | |
| | |
| | |
| | |
| | |

Use a separate sheet for additional claim/site names, serial numbers, and claimant names and addresses.

United States Department of the Interior
 Bureau of Land Management
 LANDS/RECREATION & PLANNING
 ONE N CENTRAL AVE
 PHOENIX, AZ 85004 -2203
 Phone: 602-417-9200

Receipt

No: 2647437

| | | |
|---|--|------------------------------|
| Transaction #: 2728208 | | ENTERED INTO COMPUTER |
| Date of Transaction: 08/31/2012 | | |
| CUSTOMER: | | SEP 13 2012 <i>PC</i> |
| DWIGHT WILLIAMS PO BOX 549 SALOME, AZ 85348-0549 US | | |

| LINE # | QTY | DESCRIPTION | REMARKS | UNIT PRICE | TOTAL |
|---------------|------|---|-----------------------------|------------|-----------------|
| 1 | 1.00 | LOCATABLE MINERALS / MINING CLAIMS-NEW, UNADJUD, ONE OR MORE AUTH NOS / NEW MINING CLAIM PROCESSING FEE \$15 CASES: AMC417345/\$15.00 | | - n/a - | 15.00 |
| 2 | 1.00 | LOCATABLE MINERALS / MINING CLAIMS-NEW, UNADJUD, ONE OR MORE AUTH NOS / NEW MINING CLAIM LOCATION FEE \$34 CASES: AMC417345/\$34.00 | | - n/a - | 34.00 |
| 3 | 1.00 | LOCATABLE MINERALS / MINING CLAIMS-NEW, UNADJUD, ONE OR MORE AUTH NOS / NEW MINING CLAIM MAINT FEE \$140 CASES: AMC417345/\$140.00 | | - n/a - | 140.00 |
| 4 | 1.00 | LOCATABLE MINERALS / MINING CLAIMS-NOT NEW-UNADJUD, ONE AUTH NO. ONLY / MINING CLAIM MONEY RECEIVED CASES: AMC417346/\$280.00 | MAINT (1) 2012, 2013 (1) | - n/a - | 280.00 |
| TOTAL: | | | | | \$469.00 |

| PAYMENT INFORMATION | | | |
|---------------------|-----------|---|----------------------|
| 1 | AMOUNT: | 469.00 | POSTMARKED: N/A |
| | TYPE: | CHECK | RECEIVED: 08/31/2012 |
| | CHECK NO: | 25327 | |
| | NAME: | WILLIAMS, DWIGHT PO BOX 549 SALOME AZ 85348-0549 US | |

NOTICE!!

These documents have been scanned!

Do not place un-scanned documents beneath this notice!

Do not remove this notice from this file!

GPO Jacket No. 560-102
Print Order 61540
Rise Business Services, LLC
Job=AZ15 5/13/2019



Box Number= AZ15045



Claim Begin-End: AMC417345-AMC417345

6 Location Notices-Amendments and Supporting Documents



AZ15045-9

AMC416896-AMC417639

**DEPARTMENT OF THE INTERIOR
BUREAU OF LAND MANAGEMENT**

MINING CLAIMS

(LIVE) Serial Register Page

Run Date/Time: 09/13/2012 07:04 AM

Page 1 of 1

01 05-10-1872;017STAT0091;30USC26,28,34
 Case Type 384101: LODE CLAIM
 Claim Name: BONNY GOLD
 Commodity :
 Case Disposition: ACTIVE
 Required Maintenance Fee: \$140.00

Total Acres
 20.660

Serial Number
 AMC417345
 Lead File Number
 AMC417345

| Name & Address | | | | Int Rel | % Interest |
|-----------------|------------|-----------------------|-----------|-----------------------|------------|
| WILLIAMS DWIGHT | PO BOX 549 | SALOME, AZ 85348-0549 | | CLAIMANT | 0.0000000 |
| WILLIAMS LORI | PO BOX 549 | SALOME, AZ 85348-0549 | | CLAIMANT | 0.0000000 |
| Mer Twp | Rng | Sec | Quadrant | District/Field Office | County |
| 14 | 0040N | 0130W | 001 SW,SE | LAKE HAVASU FO | LA PAZ |

| Act Date | Code | Action | Action Remarks | Receipt Number |
|------------|------|-----------------------------|----------------|----------------|
| 06/11/2012 | 403 | LOCATION DATE | | |
| 08/31/2012 | 395 | RECORDATION NOTICE RECD | 1 | 2647437 |
| 08/31/2012 | 682 | MAINTENANCE FEE/\$140 | 2013;\$140 | 2647437 |
| 08/31/2012 | 484 | LOCATION YEAR / MAINTENANCE | 2012;\$140 | 2647437 |
| 08/31/2012 | 501 | ACCT ADV IN LEAD FILE | AMC417345; | |

Line Nr Remarks

**DEPARTMENT OF THE INTERIOR
BUREAU OF LAND MANAGEMENT
MINING CLAIMS**

(LIVE) Serial Register Page

Run Date/Time: 09/13/2012 06:57 AM

Page 1 of 1

01 05-10-1872;017STAT0091;30USC26,28,34

Total Acres
20.660

Serial Number
AMC417345
Lead File Number
AMC417345

Case Type 384101: LODE CLAIM

Claim Name: BONNY GOLD

Commodity :

Case Disposition: ACTIVE

Required Maintenance Fee: \$140.00

| Name & Address | | | | Int Rel | % Interest |
|-----------------|------------|-----------------------|----------|-----------------------|-----------------------|
| WILLIAMS DWIGHT | PO BOX 549 | SALOME, AZ 85348-0549 | | CLAIMANT | 0.0000000 |
| WILLIAMS LORI | PO BOX 549 | SALOME, AZ 85348-0549 | | CLAIMANT | 0.0000000 |
| Mer Twp | Rng | Sec | Quadrant | District/Field Office | County |
| 14 | 0040N | 0130W | 001 | SW,SE | LAKE HAVASU FO LA PAZ |

| Act Date | Code | Action | Action Remarks | Receipt Number |
|------------|------|-----------------------------|----------------|----------------|
| 06/11/2012 | 403 | LOCATION DATE | | |
| 08/31/2012 | 395 | RECORDATION NOTICE RECD | 1 | 2647437 |
| 08/31/2012 | 484 | LOCATION YEAR / MAINTENANCE | 2012;\$140 | 2647437 |
| 08/31/2012 | 501 | ACCT ADV IN LEAD FILE | AMC417345; | |

Line Nr Remarks

MILING CLAIM STATUS REPORT

SEP 13 2012 ^{PR}

DATA ENTERED SEP 13 2012 ^{PR}

MTP Checked by SEP 13 2012 ^{PR}
GEO Checked by ^{PR}

LEAD SERIAL NUMBER AMC 417345 thru AMC _____

| # OF CLAIMS & TYPE | | CHARGES |
|----------------------------|---------------------------|----------------------|
| # <u>1</u> LODGE | Location Fee @ \$34 = | \$ <u>34</u> |
| # _____ PLACER | Processing Fee @ \$15 = | \$ <u>15</u> |
| # _____ ASSOCIATION PLACER | Maintenance Fee @ \$140 = | \$ <u>140</u> |
| # _____ MILL SITE | Overage (+) | \$ _____ |
| # _____ TUNNEL SITE | Shortage (-) | \$ _____ |
| | 2012-2013 - Other Fees | \$ <u>280</u> |
| | TOTAL | \$ <u>469</u> |

TOTAL CLAIM ACREAGE? _____

OF LOCATORS? _____

DOCUMENTS RECEIVED VIA - Over-the-Counter () Mail ()
TIMELY FILED? Yes () No ()

LEGAL DESCRIPTION - T 4N R 13W SEC 001
 T _____ R _____ SEC _____
 T _____ R _____ SEC _____
 T _____ R _____ SEC _____

BLM () FOREST SERVICE () _____ SUBJ TO PL 359: Yes () No ()
WILDERNESS AREA: No () Yes () _____

SPLIT ESTATE - N/A () SX () PX () SRHA () OTHER () _____
Proper Notice Filed if Located on SHRA Lands? N/A () Yes () No ()

RECONVEYED MINERALS ON BLM LANDS REQUIRE OPENING ORDERS FROM 1944 TO 1993 -
Open to Entry on: _____ N/A ()

COMMENTS/STATUS - VOID () PARTIALLY VOID () PVT MINERALS () WITHDRAWN LANDS ()
OTHER () No signature

Claimant acknowledges that portions of the following claims(s) site(s) may be void or voidable.

Printed Name of Claimant _____ Signature of Claimant _____

***** FINAL ADJUDICATION *****

DATE 3/12/13 INITIALS AT

AMC417344

2EB 14 1944
2EB 4 18 1945

2EB 14 1944

LOCATION NOTICE FOR LODE MINING CLAIM

NOTICE IS HEREBY GIVEN that the Bonny Gold
lode mining claim has been located
by Dwight Williams whose current mailing
address is P.O. Box 549
Salome, AZ 85348

RECEIVED
BLM AZ STATE OFFICE
2012 AUG 31 P 3:55
PHOENIX, ARIZONA
BLM
Date
Stamp

The general course of this claim is North + South and it is situated in La Paz
County, Arizona. This claim is 1500 feet in length and 600 feet in width. This claim runs
from the location monument on which this location notice is posted approximately 600 feet in a
East direction to the NE end line and 1500 feet in a South direction to the
SE end line. This claim is marked by six monuments, one at each corner and one at the center of each
end line of the claim.

The location monument on which this notice is posted is situated within Section 1, Township 4
N, Range 13 W, Gila Salt River Base and Meridian, Arizona and this claim encompasses portions
of the following quarter section (s), section (s), Township (s) and Range (s) NW, NE, SW, SE,
Section 1, Township 4N, Range 13W
Gila Salt River Base and Meridian, Arizona.

The locality of this claim with reference to some natural object or permanent monument and additional information
(if any) concerning its locality are as follows: The monument marker is 100 feet west
+ 30 feet North of the SE corner of the NW section of
Section 1, Township 4N, Range 13W.

DATED AND POSTED on the ground this 11th day of June, 2012.

LOCATOR (s) Dwight Williams, Lori Williams

Form MCF100
Revised July 2005

MINING CLAIM MAP

Lode (✓) Placer ()

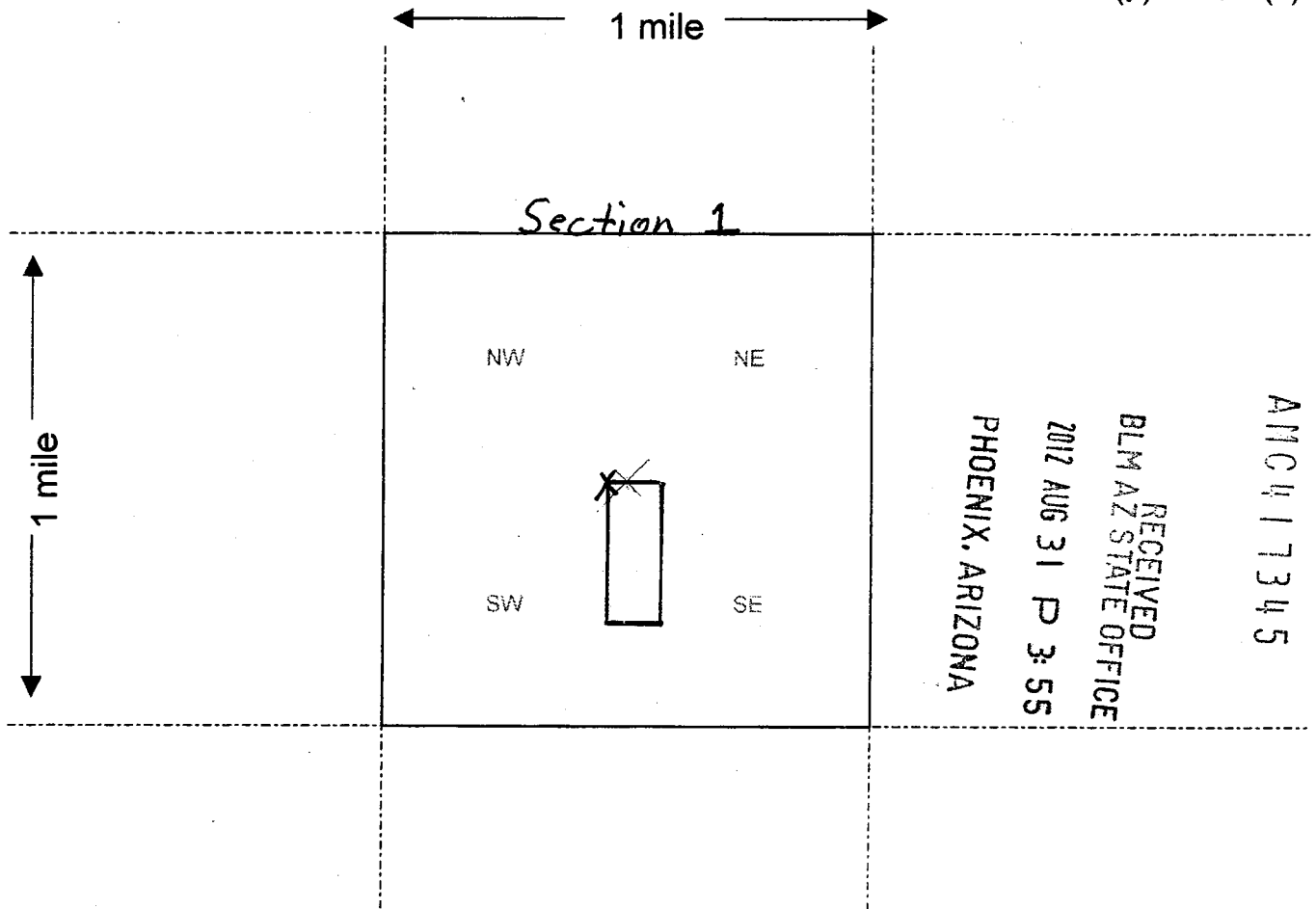

Scale : 1" = 2000 feet



1. The above map depicts the Bonny Gold mining claim, which is located in Section (s) 001, Township 4 N, Range 13 W, Gila and Salt River Base and Meridian, La Paz County, Arizona.

2. The type of corner and location monuments used are as follows: 2x4 wooden posts.

3. The bearings and distances in degrees and feet between claim corners are as depicted on the map.

Form MCF100a
Revised July 2005

This form is available from the Arizona Department of Mines & Mineral Resources and may be reproduced.

Input Parameters for Geographic Report with Land

System Id = CR

Admin State = AZ

Geo State = AZ

Casetype Begins With

Case Disp Txt = AUTHORIZED, CANCELLED, EXPIRED, PENDING, REJECTED, RELINQUISHED, WITHDRAWN

Mer Twp Rng =

Section =

Mtrs = 14 0040N 0130W 001, 14 0040N 0130W 999

Commodity =

Commodity Txt =

Pending Org =

Pend Org Decode =

Total Rows Returned: 0

UNSURVEYED TOWNSHIP 4 NORTH RANGE 13 WEST OF THE GILA AND SALT RIVER MERIDIAN, ARIZONA

LA PAZ COUNTY

STATUS OF PUBLIC DOMAIN
LAND AND MINERAL TITLES

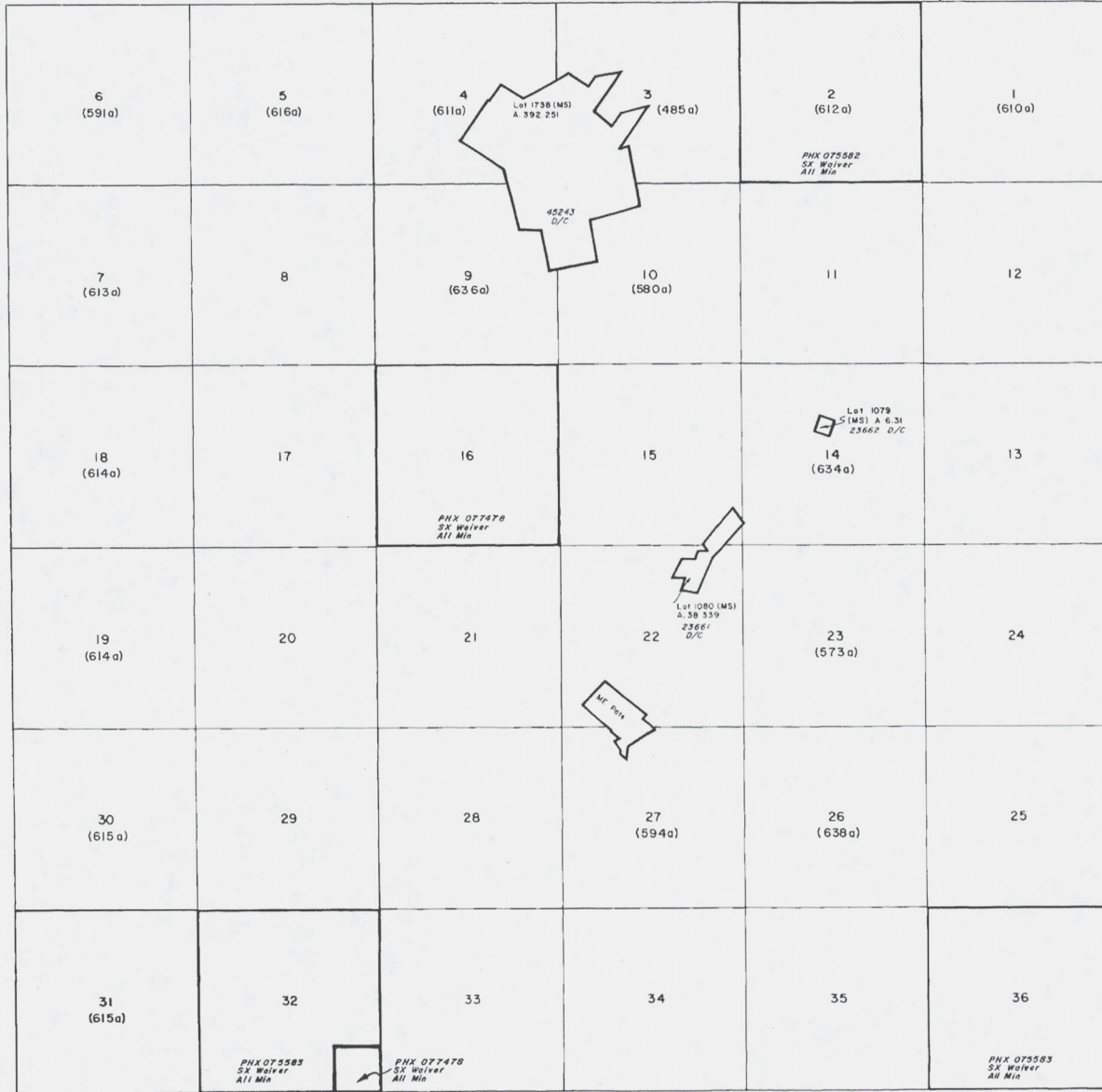

| INDEX TO SEGREGATED TRACTS | | | | |
|----------------------------|-----------------|---|-----|-------------|
| RESURVEY | ORIGINAL SURVEY | | | |
| TRACT NO | T | R | SEC | SUBDIVISION |
| | | | | |
| | | | | |
| | | | | |
| | | | | |
| | | | | |
| | | | | |
| | | | | |
| | | | | |
| | | | | |
| | | | | |
| | | | | |
| | | | | |

FOR ORDERS AFFECTING DISPOSAL OR USE OF UNIDENTIFIED LANDS WITHDRAWN FOR CLASSIFICATION, MINERALS, WATER AND/OR OTHER PUBLIC PURPOSES, REFER TO INDEX OF MISCELLANEOUS DOCUMENTS.

PROTRACTION DIAGRAM NO 19

DIST NO 5

GRAZING DIST NO 2

MIS. 364 NE
365 NW
366 SE

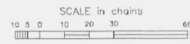

WARNING STATEMENT
This plat is the Bureau's Record of Title, and should be used only as a graphic display of the bounding survey data. Records hereon do not reflect title changes which may have been effected by lateral movements of rivers or other bodies of water. Refer to the cadastral surveys for official survey information.

| CURRENT TO | GS | T | R |
|------------|-----------|-----|------|
| 8-28-2002 | PV USE | 4 N | 13 W |